



Project _____

Item _____ Quantity _____

Approved by _____ Date _____

AIA/SIS # _____

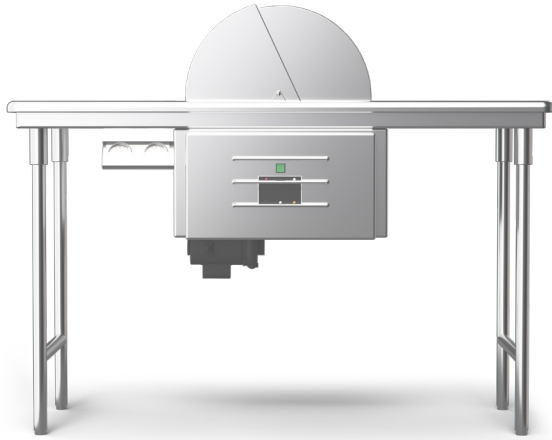

ENSIGN 40-2

Counter Top Dishwasher



STANDARD FEATURES

- Washes 43 racks (16" x 16") per hour
- Drop-in design (does not include table)
- Fully automatic operation
- Space-saving roll-top design
- Automatic tank fill
- Detergent connection provision
- Door safety switch
- Low water protection
- Manifold clean-out brush
- Side mounted control panel (NEMA 12)
- Simplified scrap screen design
- Single piece drain plug
- Single point electrical connection: motor, controls, tank heat (Optional booster requires separate connection)
- Standard frame drip proof motor
- Thermometer for final rinse
- Thermometer for wash
- Vacuum breaker

43

Racks Per Hour

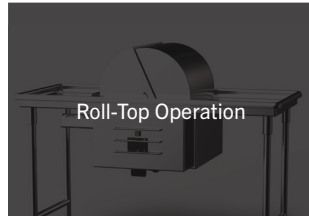

Roll-Top Operation



Compact Design



Made in the USA

OPTIONS & ACCESSORIES

- 16" x 16" dish racks (peg or flat)
- Drain cooldown
- Electric booster
- Pressure reduction valve and line strainer
- Scale inhibitor
- Stainless steel frame
- Stainless steel steam coil tank heat
- Steam booster
- Totally enclosed motor

SPECIFIER STATEMENT

Specified unit will be an Insinger Ensign 40-2 counter top dishwasher. Features include automatic tank fill, detergent connection provision, fully automatic operation, electric immersion tank heat, and a compact space-saving design. Includes a 1-year parts and labor warranty.

TECHNICAL INFORMATION

TOP

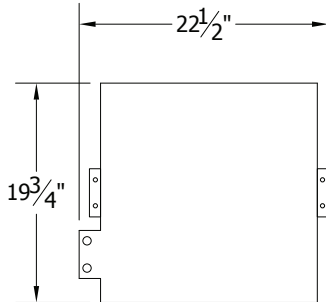

SIDE

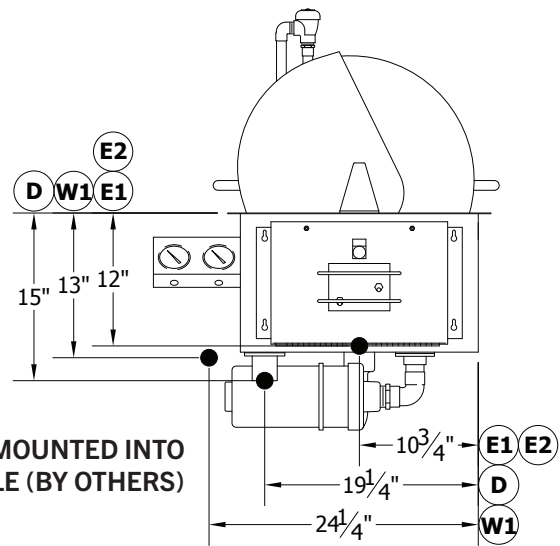

NOTE: PRODUCT MOUNTED INTO
STAINLESS STEEL TABLE (BY OTHERS)

FRONT

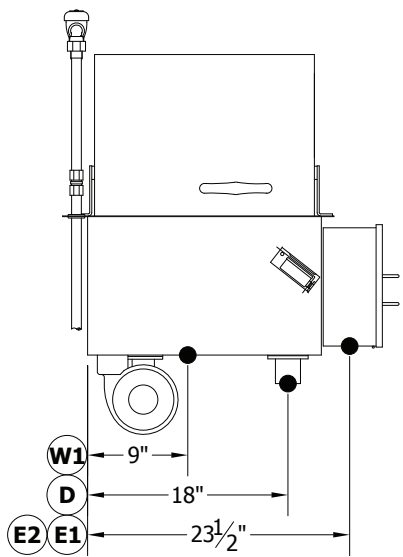

BOOSTER
(OPTIONAL)

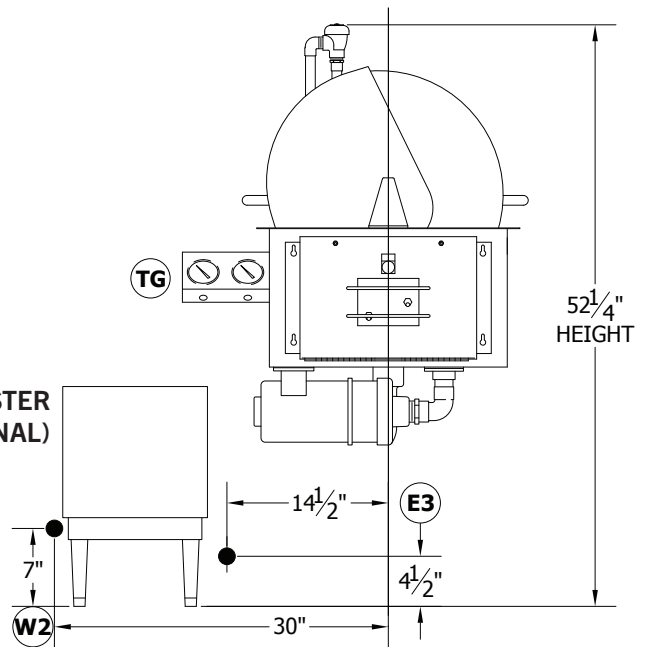

SPECIFICATIONS

Capacity	Racks Per Hour (16" x 16")	43
	Dishes Per Hour	720
Heating & Venting	Wash Tank Heat	1.5 kW
	Booster Heat (40°F Rise)	6 kW
	Booster Heat (70°F Rise)	12 kW
	Water Inlet Temperature	140°F
Water	Water Consumption (20 PSI)	.75 gal/rack
	Wash Tank Capacity	8.1 gal
	Peak Drain Flow	9 gal/min
	Steam Tank Consumption (20 PSI)	6 lbs/hr
Steam	Steam Consumption (20 PSI, 40°F Rise Booster)	22 lbs/hr
	Steam Consumption (20 PSI, 70°F Rise Booster)	38 lbs/hr
	Wash Motor	1.0 HP
Other	Shipping Weight	400 lbs

ELECTRICAL

	Service Options	Ensign 40-2 (Electric)	6 kW Booster	12 kW Booster
Electric Tank Heat	115/60/1	23.7 A	Contact Factory	
	208/60/1	15.0 A	28.9 A	57.7 A
	208/60/3	6.9 A	25 A	33.4 A
	240/60/1	11.8 A	25 A	50 A
	240/60/3	6.0 A	21.6 A	28.9 A
	380/50/3	3.8 A	Contact Factory	
	480/60/3	3.1 A	10.8 A	14.5 A
		Service Options	Ensign 40-2 (Steam)	
Steam Tank Heat	115/60/1	10.7 A		
	208/60/1	7.0 A		
	208/60/3	2.7 A		
	240/60/1	5.5 A		
	240/60/3	2.4 A		
	380/50/3	1.5 A		
	480/60/3	1.4 A		

LEGEND

Type	Label	Description	Note
Water	W1	HOT WATER TO - FINAL RINSE	3/4 FIPS
	W2	HOT WATER TO - BOOSTER	3/4 FIPS
	D	DRAIN CONNECTION	1.5 FIPS
Electrical	E1	ELECTRICAL CONNECTION - MOTOR	1/2 HP
	E2	ELECTRICAL CONNECTION - HEATER	1 1/2 kW
	E3	ELECTRICAL CONNECTION - BOOSTER	6 or 12 kW
Other	TG	TEMPERATURE GAUGES FOR WASH + FINAL RINSE	INCLUDES MOUNTING BRACKET

Contact Insinger Sales at 800-344-4802 for an installation drawing specific to your application.
 Note: Due to product improvement we reserve the right to change information and specifications without notice.