



Project \_\_\_\_\_

Item \_\_\_\_\_ Quantity \_\_\_\_\_

Approved by \_\_\_\_\_ Date \_\_\_\_\_

AIA/SIS # \_\_\_\_\_



# SW25

Pot & Pan Washer

## STANDARD FEATURES

- Fully automatic operation
- Designed for heavy duty applications
- Waterproof LED digital gauges
- Automatic fill and drain
- Capillary thermometer for wash and final rinse
- Detergent connection provision
- Inspection door
- Low water protection
- Manifold clean-out brush
- Pressure regulator to maintain 20 psi rinse flow
- Simple scrap screen
- Single point electrical connection
- Stainless steel frame, legs and feet
- Stainless steel front panel
- Standard frame drip proof motors
- Vent opening with adjustable damper



# 25

Pans Per Rack

Military-Grade Build Quality

High-Velocity  
Spray Nozzles



Made in the USA

## OPTIONS & ACCESSORIES

- Rack assortment: general utility, bake sheet, utensil basket
- Recommended option: power vent fan
- Security package
- Steam booster
- Totally enclosed motor
- Wash tank heat system: Electric
- Wash tank heat system: Gas
- Wash tank heat system: Steam Coil
- Wash tank heat system: Steam Injection

## SPECIFIER STATEMENT

Specified unit will be a SW25 pot and pan washer. Features include automatic fill and drain, capillary thermometer for wash and final rinse, fully automatic operation, low water protection, and waterproof LED digital gauges. Includes a 1-year parts and labor warranty.

# TECHNICAL INFORMATION

TOP

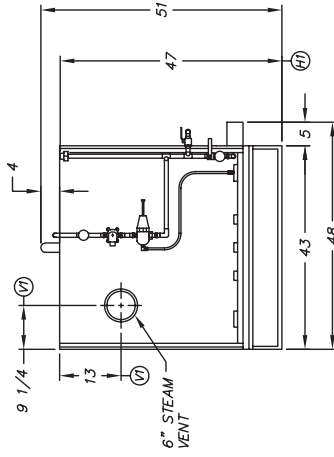

FRONT

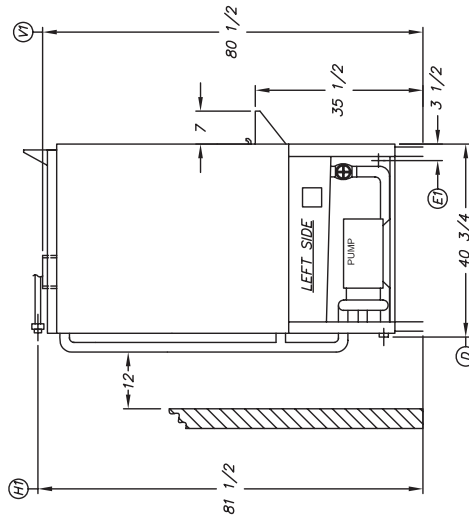

SIDE

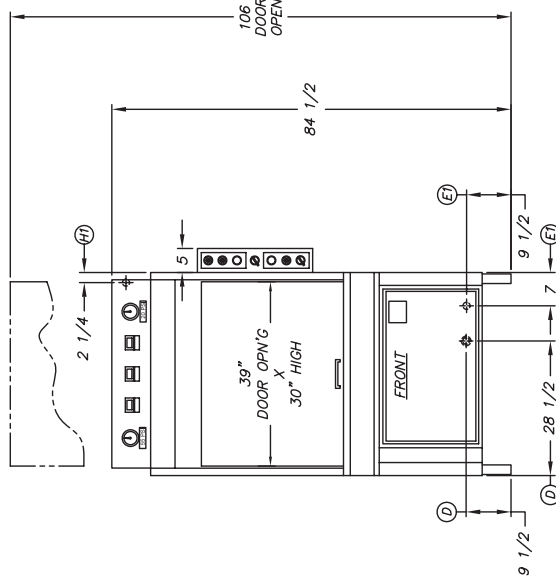

## SPECIFICATIONS

<b>Capacity</b>	Pans Per Rack	25
	Sheet Pans Per Hour	300
<b>Heating &amp; Venting</b>	Wash Tank Heat	9 kW
	Rinse Booster Heat	9 kW
	Exhaust Hood Requirement	6" Steam Exhaust Vent
	Water Inlet Temperature	110°F
<b>Water</b>	Water Consumption (20 PSI)	78 gal/hr
	Wash Tank Capacity	40 gal
	Final Rinse Peak Flow (20 PSI)	4.7 gal/cycle
	Peak Drain Flow	6 gal/min
	Steam Tank Consumption (Injected, 10-15 PSI)	23 lbs/hr
<b>Steam</b>	Steam Tank Consumption (Coil, 10-15 PSI)	43 lbs/hr
	BTUH Capacity	48,000
<b>Gas</b>	Natural Gas Consumption (7" W.C. Minute)	47 CFH
	Propane Consumption (11" W.C. Minute)	19 CFH
	Wash Motor HP	10
<b>Other</b>	Shipping Weight	1250 lbs

## ELECTRICAL

	Service Options	SW25 (Electric)	SW25 (Gas)	SW25 (Steam)
<b>Electrical Options</b>	208/60/3	79.1 A	29.1 A	54.1 A
	230/60/3	71.5 A	26.3 A	48.9 A
	460/60/3	36.8 A	14.2 A	25.5 A

Contact Insinger Sales at 800-344-4802 for an installation drawing specific to your application.  
 Note: Due to product improvement we reserve the right to change information and specifications without notice.