



Vessel \_\_\_\_\_

Item \_\_\_\_\_ Quantity \_\_\_\_\_

Approved by \_\_\_\_\_ Date \_\_\_\_\_

NSN # \_\_\_\_\_



# GALLEYMASTER™

Modular Rack Conveyor Scullery System



## 60-250

Racks Per Hour



CrossFire™ Wash System

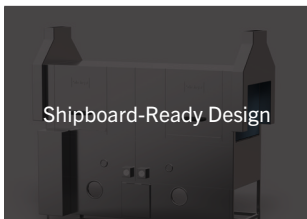

Shipboard-Ready Design



Made in the USA

## MODELS

- GalleyMaster™ 60
- GalleyMaster™ 85
- GalleyMaster™ 135
- GalleyMaster™ 185
- GalleyMaster™ 250

## STANDARD FEATURES

- Bulk-head mounted NEMA 12 control panel
- ColorCorrect dish curtains
- Complies with ASTM specification F859-04
- CrossFire™ wash system cleans from top, bottom and sides
- Exact footprint replacement for USN72 Series
- Meets Shipboard Military Specification
- Modular design for tight installations (fits through 26" x 66" water-tight hatch)
- Connection points for detergent and rinse aid dispensers
- Detergent probe hole in bottom of wash tank
- Electrical interlock switch on each door
- External conveyor drive system (HTD) with frictionless overload release
- Hermetically sealed and tank mounted thermometers for wash and final rinse designed to minimize breakage
- Inspection doors with welded handles
- Integrated vent cowl system with dampers
- Left or right hand configuration
- Locking plungers and keys on spray pipes
- Loss proof wire lanyards on suction strainers, overflow tubes, and spray pipe end plugs
- Low water protection
- Manual tank filling system
- Manifold clean-out brush
- NEMA 4 control switches
- Permanent deck-mounting legs on the rinse tank
- Plastic 20" x 20" dish racks (peg or flat)
- Porthole liquid level indicator on wash and rinse tanks
- Premium ball valves on all water and steam lines
- Pressure reduction valve and line strainer
- Simplified scrap screen design
- Standard frame TE motors
- Stainless steel frame, legs, feet and front panels
- Two safety catches on each door
- Vacuum breaker on all incoming water lines

# TECHNICAL INFORMATION

## LEFT TO RIGHT

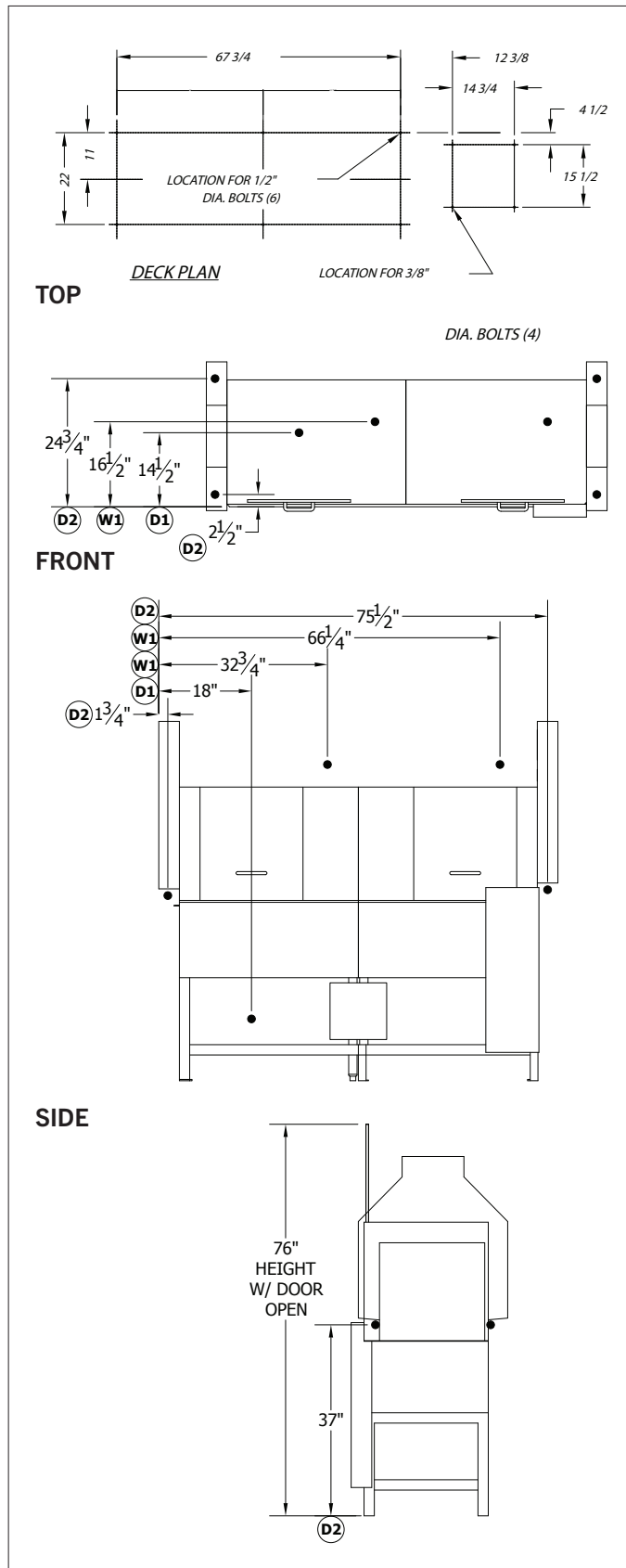

## RIGHT TO LEFT

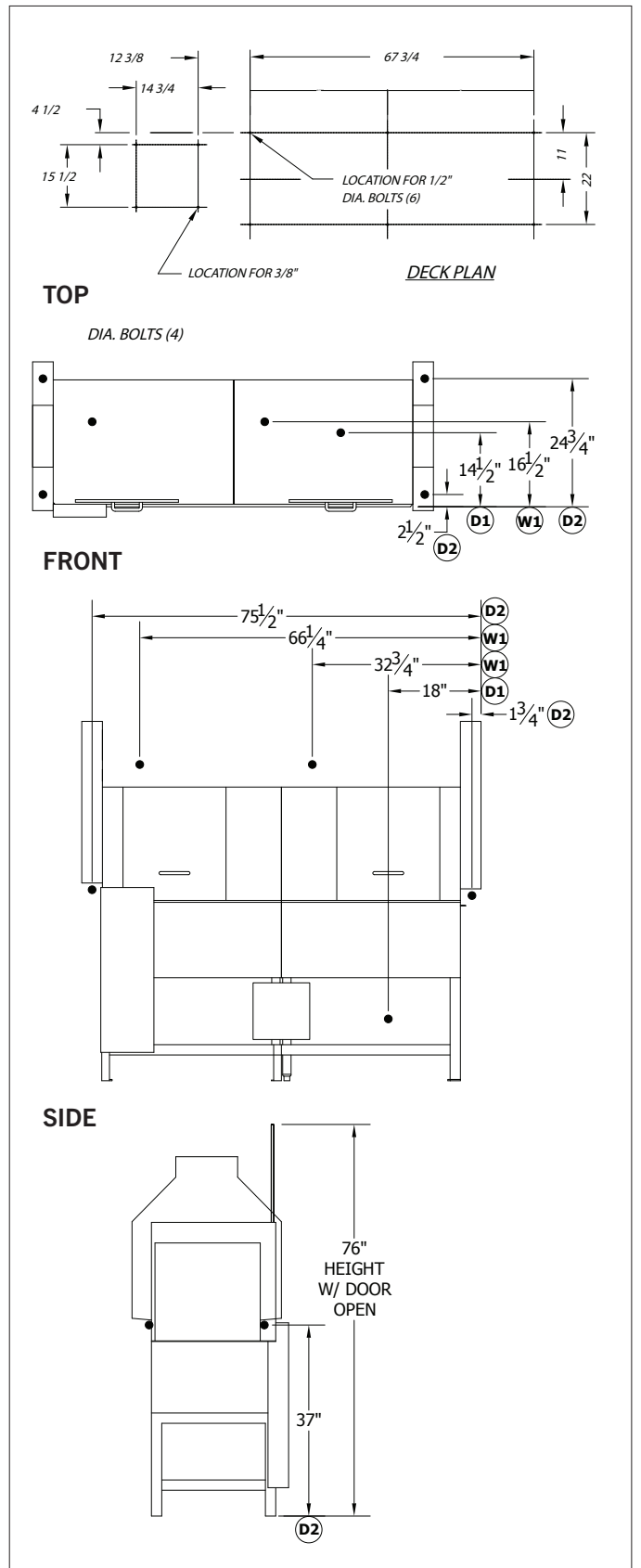

# TECHNICAL INFORMATION (ELECTRIC)

LEFT TO RIGHT

TOP

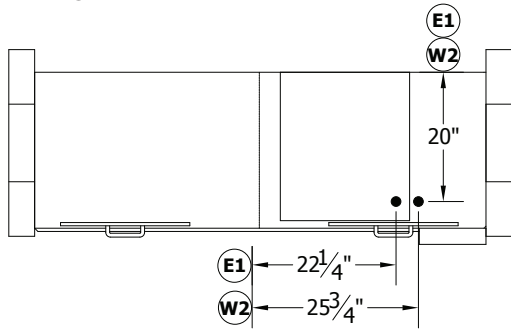

RIGHT TO LEFT

TOP

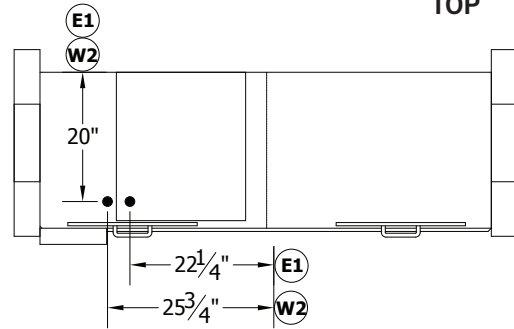

FRONT

ELECTRIC BOOSTER

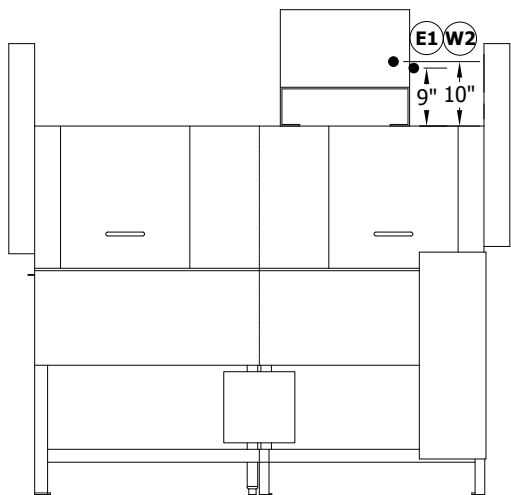

NOTE: ELECTRIC BOOSTER MOUNTS ON TOP OF MACHINE

ELECTRIC BOOSTER

FRONT

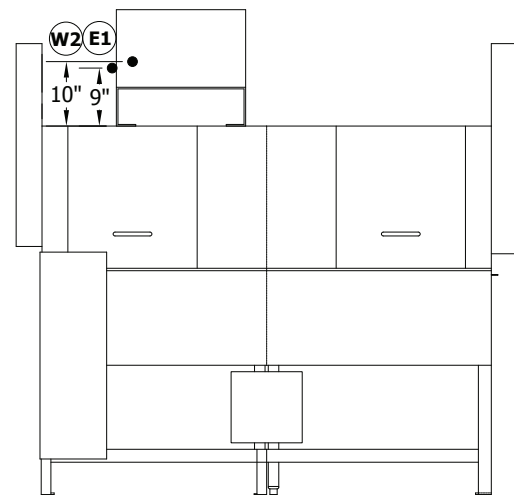

NOTE: ELECTRIC BOOSTER MOUNTS ON TOP OF MACHINE

# TECHNICAL INFORMATION (STEAM)

LEFT TO RIGHT

TOP

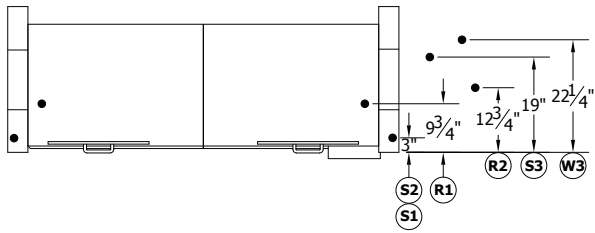

FRONT

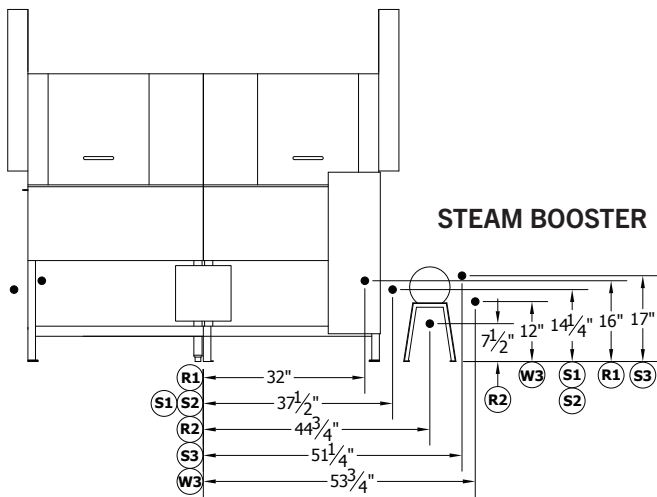

**NOTE: STEAM BOOSTER MOUNTS TO DECK  
BENEATH DISH TABLES**

RIGHT TO LEFT

TOP

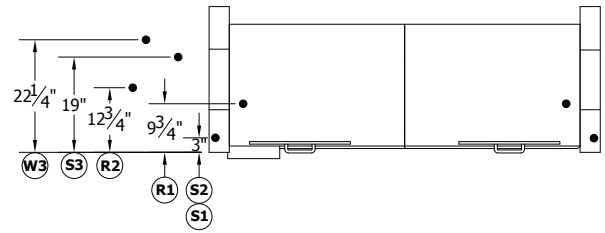

FRONT

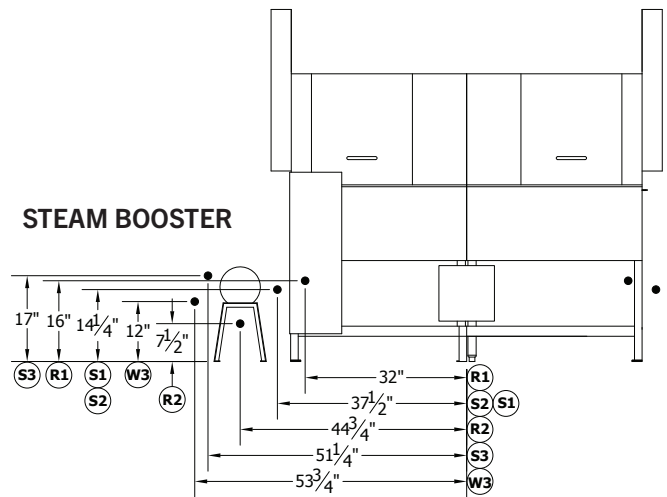

**NOTE: STEAM BOOSTER MOUNTS TO DECK  
BENEATH DISH TABLES**

## SPECIFICATIONS

Capacity Options	Racks Per Hour (GM 60)	60
	Racks Per Hour (GM 85)	85
	Racks Per Hour (GM 135)	135
	Racks Per Hour (GM 185)	185
	Racks Per Hour (GM 250)	250
Heating & Venting	Wash Tank Heat	15 kW
	Rinse Tank Heat	22.5 kW
	Rinse Booster Heat	54 kW
	Venting (Load End)	200 CFM
	Venting (Unload End)	500 CFM
Water	Water Consumption (20 PSI)	34 gal/hr
	Wash Tank Capacity	12 gal
	Peak Drain Flow	14 gal/min
Steam	Steam Wash Tank Consumption (20 PSI)	55 lbs/hr
	Steam Rinse Tank Consumption (20 PSI)	82 lbs/hr
	Steam Rinse Booster Consumption (20 PSI)	109 lbs/hr
Other	Drive Motor HP	1/15
	Wash Motor HP	1.0
	Rinse Motor HP	1.0
	Shipping Weight	400 lbs

## OPTIONS & ACCESSORIES

- Power loader
- Power unloader
- Rack limit switch
- Electric Heat (Qty. 5 x 7.5 kW, 54 kW booster)
- Steam Heat (Qty. 2 x sealed stainless steel steam coils, Steam booster)

## ELECTRICAL

	Service Options	GalleyMaster™ (Electric)	GalleyMaster™ (Steam)
Electrical Service (440/60/3)	Motor & Controls	4.9 A	4.9 Total Amps
	Wash Tank Heaters	16.5 A	N/A
	Rinse Tank Heaters	24.8 A	N/A
	Final Rinse Booster	70.9 A	N/A

## LEGEND

Type	Label	Description	Note
Water	<b>W1</b>	HOT WATER TO TANK FILLS - 140F	1/2 FIPS
	<b>W2</b>	HOT WATER TO ELECTRIC BOOSTER - 140F	3/4 FIPS
	<b>W3</b>	HOT WATER TO STEAM BOOSTER - 140F	1/2 FIPS
	<b>D1</b>	DRAIN CONNECTION - MACHINE	2 FIPS
Electrical	<b>D2</b>	DRAIN CONNECTION - VENT COLLARS	3/4 FIPS
	<b>E1</b>	ELECTRICAL CONNECTION - CONVEYORS & PUMPS	2.1 HP
	<b>E2</b>	ELECTRICAL CONNECTION - WASH HEAT	15 kW
	<b>E3</b>	ELECTRICAL CONNECTION - RINSE HEAT	22.5 kW
Steam	<b>E4</b>	ELECTRICAL CONNECTION - BOOSTER	54 kW
	<b>S1</b>	STEAM TO WASH COIL	3/4 FIPS
	<b>S2</b>	STEAM TO RINSE COIL	3/4 FIPS
Other	<b>S3</b>	STEAM TO BOOSTER	3/4 FIPS
	<b>R1</b>	CONDENSATE RETURN - COILS	3/8 FIPS
	<b>R2</b>	CONDENSATE RETURN - BOOSTER	3/8 FIPS

## NSN IDENTIFICATION

### GALLEYMASTER™ 60

NSN	Feature	Heat System	Electrical
7320-01-537-7467	Left Hand	Steam   I-2 Booster	440V / 60HZ / 3PH
7320-01-537-7471	Right Hand		
7320-01-537-7561	Left Hand	Electric   54 kW Booster	
7320-01-537-7896	Right Hand		

### GALLEYMASTER™ 85

NSN	Feature	Heat System	Electrical
7320-01-537-7473	Left Hand	Steam   I-2 Booster	440V / 60HZ / 3PH
7320-01-537-7476	Right Hand		
7320-01-537-7899	Left Hand	Electric   54 kW Booster	
7320-01-537-7900	Right Hand		

### GALLEYMASTER™ 135

NSN	Feature	Heat System	Electrical
7320-01-537-7477	Left Hand	Steam   I-2 Booster	440V / 60HZ / 3PH
7320-01-537-7507	Left Hand with Unloader		
7320-01-537-7478	Right Hand		
7320-01-537-7502	Right Hand with Unloader		
7320-01-537-7907	Left Hand	Electric   54 kW Booster	
7320-01-537-7917	Left Hand with Unloader		
7320-01-537-7909	Right Hand		
7320-01-537-7922	Right Hand with Unloader		

## NSN IDENTIFICATION

### GALLEYMASTER™ 185

NSN	Feature	Heat System	Electrical
7320-01-537-7481	Left Hand	Steam   I-2 Booster	440V / 60HZ / 3PH
7320-01-537-7515	Left Hand with Unloader		
7320-01-537-7485	Right Hand		
7320-01-537-7518	Right Hand with Unloader		
7320-01-537-7912	Left Hand	Electric   54 kW Booster	
7320-01-537-7926	Left Hand with Unloader		
7320-01-537-7913	Right Hand		
7320-01-537-7930	Right Hand with Unloader		

### GALLEYMASTER™ 250

NSN	Feature	Heat System	Electrical
7320-01-537-7488	Left Hand	Steam   I-2 Booster	440V / 60HZ / 3PH
7320-01-537-7519	Left Hand with Unloader		
7320-01-537-7491	Right Hand		
7320-01-537-7522	Right Hand with Unloader		
7320-01-537-7914	Left Hand	Electric   54 kW Booster	
7320-01-537-7935	Left Hand with Unloader		
7320-01-537-7916	Right Hand		
7320-01-537-7936	Right Hand with Unloader		